

DIMENSIONS

unit = mm

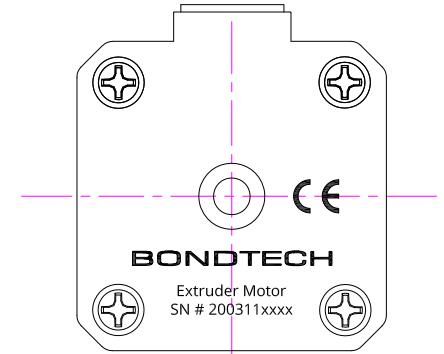

Label by laser engraving
SN # code by:
YYMMDD+4 series number

DIAGRAM

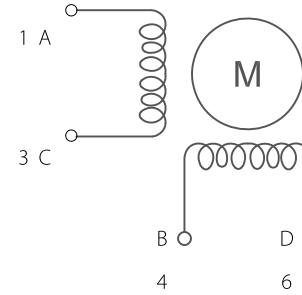

Property	Specification	Property	Specification
Number of Phases	2	Step Angle	1.8° ±5%
Rated Voltage	DC 3.1V	Rated Current	DC 0.7 A (Peak Value)
Phase Resistance	4.4 Ω±10% (20°C)	Phase Inductance	5.5 mH±20% (1kHz 1V RMS)
Holding Torque	1.6 Kg-cm	Detent Torque	-- g-cm
Rotor Inertia	26 g-cm ²	Dielectric Strength	AC 500V / 1min / 5mA Max
Reliability	MTBF 6000+ h @24V/3000RPM	Insulation Class	H (180°C) 75K Max
Max Dynamic Load	Axial : 10N Radial : 201N	Weight	152g

Gear Specification	
Module	m=0.5
Teeth Number	z=14
Pressure Angle	a=20°
Pitch Diameter	d=7
Outside Diameter	da=8
Material	Cr12Mo1V1 or SKD11 or D2 steel

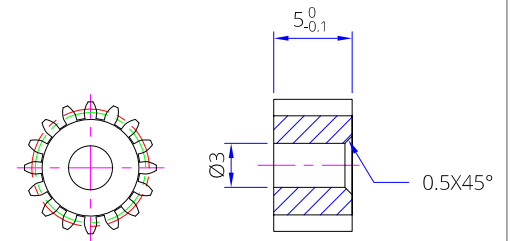

B	----				
A	----				
REV.	ECN NO.	DESCRIPTION	MADE BY	APPR. BY	DATE
		VIEW 	Bondtech AB		
		SCALE NA	Part NO. Bondtech LGX Extruder Motor 42H025H		
DRAWN BY	CHECKED BY	APPR. BY	DATE	FACTORY CODE 42H025H-0704A-005	SHEET NO. 1/1